

Libra MAX-SS 3X00

3.x GHz WiMAX Subscriber Station



Advanced WiMAX Technology

The Libra MAX-SS uses 802.16d WiMAX technology to deliver high-speed non-line-of-sight (NLOS) performance in the licensed 3.3 to 3.8 GHz range.

Optimized for outdoor environments, WiMAX offers superior range and throughput to subscribers who are not in a direct line of sight to the base station.

EION Wireless is a principal member of the WiMAX forum and as such we are committed to performing rigorous interoperability testing of our products to ensure they are compatible with the majority of WiMAX equipment.

Features

- Full spectrum of subscriber unit products for outdoor installation for residential and enterprise applications

Standards Based

- Adheres to the IEEE 802.16-2004 standard
- Based on the NP7256Wavesat chipset

Future Proof

- Remote upgrade and software management

Low Cost Design

- Low cost Today
- Aggressive cost reductions passed on to the customer
- Backed by a one year warranty

Ease of Installation

- Designed for customer installation
- Signal Strength LEDs enable simple installation and acquisition of optimum signal.



Ordering Info

Model Name	Description	Item Number
Libra MAX-SS 3X00i17	Outdoor WiMAX Subscriber Station Integrated 17dBi Antenna 3.3-3.8 GHz	9120-0107
Libra MAX-SS 3X00i20	Outdoor WiMAX Subscriber Station Integrated 20dBi Antenna 3.3-3.8 GHz	9120-0108
Libra MAX-SS 3X00e	Outdoor WiMAX Subscriber Station External Antenna 3.3-3.8 GHz	9120-0109

Specifications – Libra MAX-SS 3X00

3.x GHz WiMAX Subscriber Station

Radio

Standard

IEEE 802.16-2004

PHY Profile

256FFT OFDM

Frequency*

3.3 to 3.8 GHz

Duplex Scheme

TDD

Tx Power

+20 dBm max (3.3-3.6 GHz)

+17 dBm (3.6-3.8 GHz)

Channel Size

3.5, 7 MHz

Rx Sensitivity (10E-6 BER)

	3.5 MHz	7 MHz
BPSK 1/2	-94 dBm	-91 dBm
QPSK 1/2	-91 dBm	-90 dBm
QPSK 3/4	-90 dBm	-87 dBm
16-QAM 1/2	-87 dBm	-84 dBm
16-QAM 3/4	-84 dBm	-81 dBm
64-QAM 2/3	-80 dBm	-77 dBm
64-QAM 3/4	-78 dBm	-75 dBm

Antenna

17dBi or 20dBi integrated antenna or N-type connector

Physical, Electrical & Environmental

Enclosure

Weatherproof, IP67

Dimensions

Libra MAX-SS 3X00i17 - 10-3/8" x 8-5/8" x 2-1/2" (264mm x 219mm x 64mm)

Libra MAX-SS 3X00i20 - 16" x 14-1/4" x 2-1/2" (406mm x 362mm x 64mm)

Libra MAX-SS 3X00e - 10-3/8" x 8-5/8" x 2-1/2" (264mm x 219mm x 64mm)

Weight

Libra MAX-SS 3X00i17 - 1.79lbs (0.81kg)

Libra MAX-SS 3X00i20 - 2.2lbs (1kg)

Libra MAX-SS 3X00e - 1.79lbs (0.81kg)

Operating Temperature

-40° C to +55° C

Input Voltage

18 VDC supplied via 100-240 VAC PoE

Wireless Networking

Scheduling (QoS), External LED display (signal strength/power)

Networking Features

Routing Support, Bridging Mode, 10/100 Base T Interfaces, VLAN (802.1Q), TCP/IP Traffic Classification

Security

DES-CBC, AES,CCM, Data Security Password, Configuration Security, PKM Key Exchange

Management

Web-based GUI, SNMP, Web-based GUI, Telnet, SSH Remote software upgradeable

Regulatory Compliance

CE/Industry Canada, FCC Part 90 (3.65 GHz)

EMC: EN 301 489

Safety: EN 60950

Radio: EN 302 217

IP67, RoHS

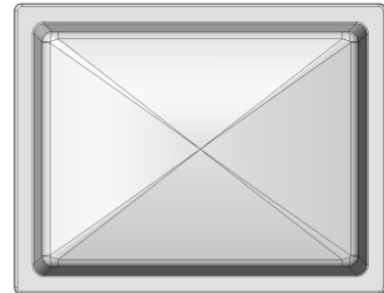

* Operational frequency and transmit power may be restricted by the vendor to meet local regulations. The operator of this product must ensure compliance with the limits specified by local regulation prior to deployment.